

Furling systems for asymmetric spinnakers and cruising chutes

This is all about enjoyment!

For every sailor who is thrilled by boat speed in combination with fast and easy sail handling, Seldén GX is a new extra member of the crew. Unfurling an asymmetric spinnaker will give you instant gratification in terms of sailing performance and true sailing pleasure.

For cruising

In light winds you can have the furled sail hoisted, ready for action. Once you are off the wind you simply release the furling line and pull on the sheet and the asymmetric spinnaker unfurls while you remain in the safety of the cockpit. You can enjoy this type of sail from about 70° apparent wind angle and when sailing dead down wind you pole it out to windward, preferably with a telescopic whisker pole. So, with a jib and an asymmetric spinnaker your performance is optimized for all wind angles. At the end of the day the furled sail is a neat, tight roll which is simple to bag and stows easily.

Top-down-furling

The sail is attached to the freely rotating tack swivel on the drum and to the halyard swivel while the luff is free flying. A rigid anti-torsion line connects the drum and the halyard swivel. When turning the drum the anti-torsion line makes the top of the sail furl first, while the tack is independent on its swivel. This makes for a tightly furled sail from top to bottom.

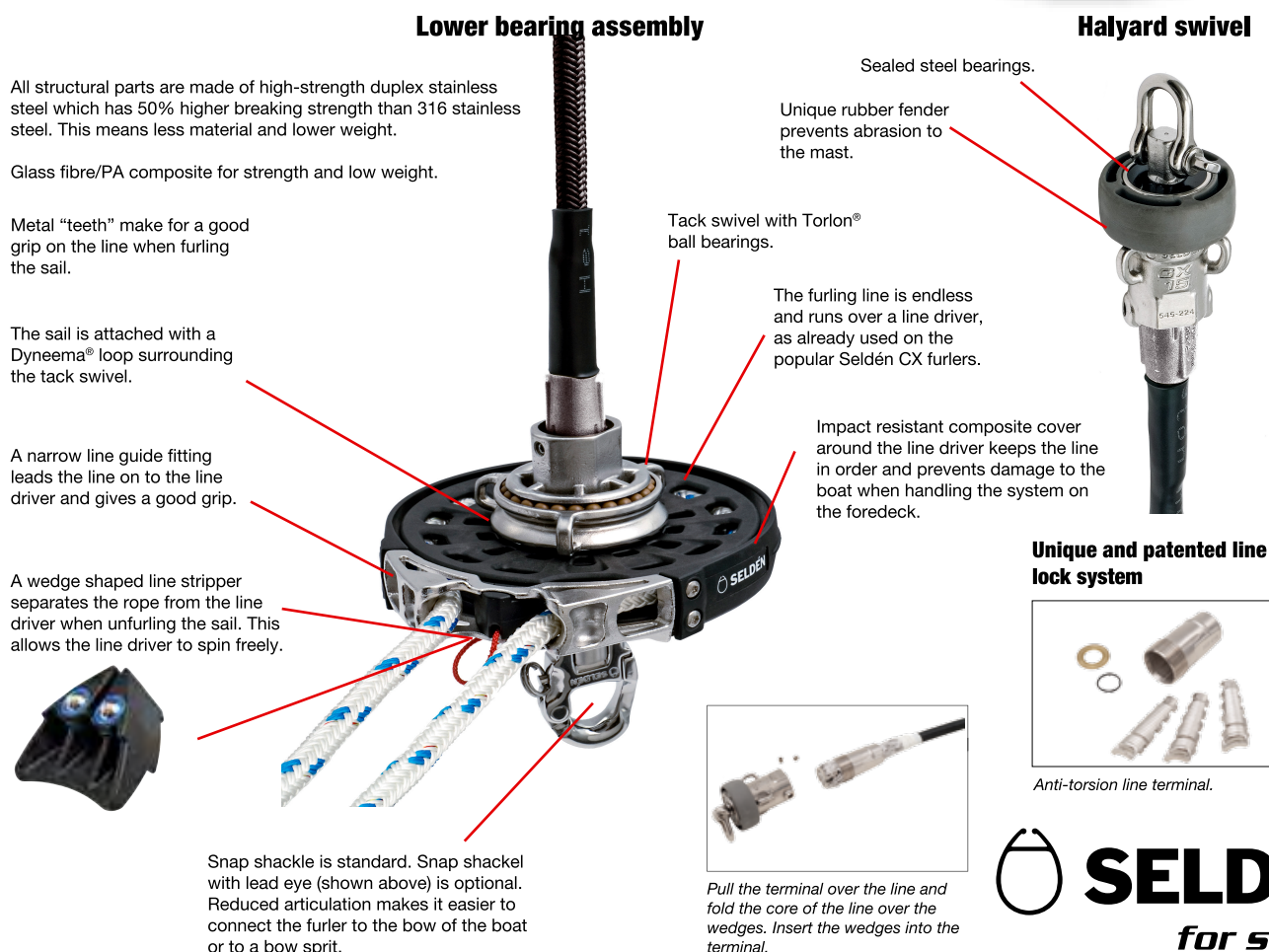





Seldén GX

Modell	Art. no.	Drum size, Ø in	Safe working-load, lb	Max recommended sail area, ft ²	Recommended retail, US\$
GX 7.5	545-018-10	4 1/8	1,685	540	\$1,165.00
GX 10	545-118-10	4 3/4	2,250	860	\$1,715.00
GX 15	545-218-10	5 7/8	3,375	1,240	\$2,128.00
GX 25	545-418-10	7 1/2	5,510	2,155	\$3,190.00

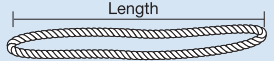

Additional equipment

Endless furling line					Tandem Block for Furling Line		Double Fairlead		Anti-Torsion Cable								
																	
Model	Art. no.	Dimension Ø in	Length, ft	Retail Price, US\$	Art. no.	Retail Price, US\$	Art. no.	Retail Price, US\$	Art. no.	Dimension, Ø mm	Length, ft	Retail Price, US\$					
GX7.5 or GX10	611-007-06	5/16	13	\$42.00	405-001-40 (GX75.-GX15)	\$159.00	480-501-01 (All line sizes)	\$117.00	613-020-01	9 (GX7.5)	42	\$295.00					
	611-007-07		26	\$69.00					613-020-02		52	\$362.00					
	611-007-09		32	\$85.00					613-020-03		62	\$431.00					
	611-007-08		39	\$104.00					613-021-01	42	\$409.00						
GX15	611-011-05	3/8	16	\$83.00	406-001-40 (GX25)	\$219.00			613-021-02	11 (GX10)	52	\$502.00					
	611-011-06		22	\$93.00					613-021-03		62	\$596.00					
	611-011-07		29	\$105.00					613-021-04		72	\$690.00					
	611-011-18		39	\$146.00					613-022-01		52	\$742.00					
	611-011-19		49	\$175.00					613-022-02	62	\$881.00						
GX25	611-015-06 611-015-07 611-015-08 611-015-09	1/2	16	\$90.00						613-022-03	72	\$1,020.00					
			613-022-04	82						\$1,159.00							
			613-022-05	92						\$1,296.00							
			613-023-01	62						\$1,240.00							
	611-015-06 611-015-07 611-015-08 611-015-09	1/2	29	\$142.00											613-023-02	72	\$1,439.00
			39	\$187.00											613-023-03	82	\$1,627.00
			56	\$261.00											613-023-04	92	\$1,828.00

Adjustable Tack Swivel

Art. no.	Model	Retail Price, US\$
545-040-10	GX7.5	\$314.00
545-140-10	GX10	\$376.00
545-240-10	GX15	\$488.00
545-440-10	GX25	\$564.00



SELDÉN and FURLEX are registered trademarks of Seldén Mast AB

Seldén Mast Inc., USA Tel 843-760-6278. Fax 843-760-1220. e-mail info@seldenus.com

 **SELDÉN**
for sailing